

# MISCELLANEOUS PARTS

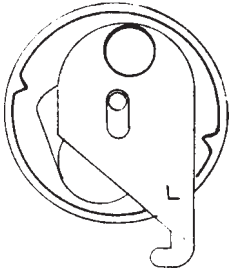

**AR-4580**  
Cam disc, reversible

**ADAMS  
RITE**



**28-0064-02** Right Hand  
**28-0064-03** Left Hand  
Replacement spring for 4160 handle.

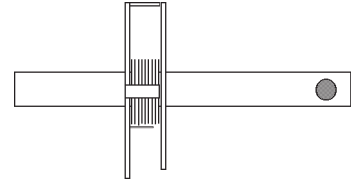

**31-0485 (HY485)**  
Spindle for 4160 handle.

**TWIN/6000 SERIES  
TWIN EXCLUSIVE SERIES**

**ASSA**



AS-867445 AS-867446 AS-867447 AS-867452 AS-867453 AS-872610

**Pins and Springs**

- AS-867065** Cylinder spring
- AS-867066** Top pin 1-2
- AS-867067** Top pin 3-4
- AS-867068** Top pin 5-6
- AS-867069** Top pin 7-8-9
- AS-867070** Master Pin 1
- AS-867071** Master Pin 2
- AS-867072** Master Pin 3
- AS-867073** Master Pin 4
- AS-867074** Master Pin 5
- AS-867075** Master Pin 6
- AS-867076** Master Pin 7
- AS-867077** Master Pin 8
- AS-867078** Bottom pin 1
- AS-867079** Bottom pin 2
- AS-867080** Bottom pin 3
- AS-867081** Bottom pin 4
- AS-867082** Bottom pin 5
- AS-867083** Bottom pin 6
- AS-867084** Bottom pin 7
- AS-867085** Bottom pin 8
- AS-867086** Bottom pin 9
- AS-867015** Side pin (Twin)
- AS-353837** Right Hand Side Pin (V-10)
- AS-353838** Left Hand Side Pin (V-10)
- AS-867087** Side pin spring (Twin)
- AS-867088** Side bar spring (Twin)
- AS-868141** Pin chamber closing strip-  
for Mort, Rim, KIK

\$-Discontinued. Call for  
closeout prices.

**Cams & Tailpieces**

- AS-867445** #1 Adams Rite Cam
- AS-867446** #3 Corbin Clover Leaf Cam
- AS-867447** #4 Corbin Bever Tail Cam
- AS-867452** #2 Sargent Cam
- AS-867453** #6 Schlage "L" Cam
- AS-867450** Horizontal & Vertical Rim Tailpiece Kit
- AS-872610** #5 Yale/Standard Cam

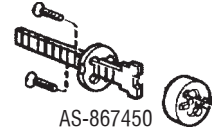

**Screws**

- \$AS-867090** Phillips Screw For Cam
- AS-868138** Slotted Screw For Rim Tailpiece
- AS-900209** Kit, includes plate and 2 screws

**INTERCHANGEABLE CORE PARTS**



**AR-001**



**AR-AM2**



**AR-004**  
N Series, Exit  
Devices, Alarms



**AR-006**  
Schlage



**AR-18**  
Adams Rite

**MORTISE HOUSING PARTS**

- | <u>Stock No.</u>      | <u>Description</u>       |
|-----------------------|--------------------------|
| <b>AR-3-48 X 3/16</b> | Cam Set Screw            |
| <b>AR-C16CR-122</b>   | Washer                   |
| <b>AR-C16CR-121A</b>  | Adaptor Assembly - 7 pin |

**Deadbolt Parts**

- \$AS-806268\*** Spacer ring for 1-3/8" thick door
  - \$AS-806269\*** Adaptor ring for 2-/8" dia. hole
- \*Specify Finish: 605, 609, 624, 626

©ZIPF LOCK COMPANY

# MISCELLANEOUS PARTS

## MISCELLANEOUS PARTS



**SC-01-060**  
605, 626  
Inside plunger unit for A53 (not ORB design)

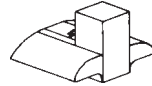

**SC-A501-615**  
To convert entrance to vestibule function (A, AL, H)

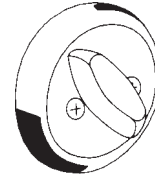

**SC-B202-671**  
605, 609, 626  
Rose and turn, no hold back for B250.

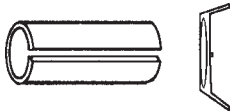

**SC-37-001 138** For 1-3/8" thick doors  
**SC-37-001 134** For 1-3/4" thick doors  
A, AL and D Series Reinforcement Kit. For when installing locks in non-reinforced hollow metal or metal clad doors.



**SC-A501-878**  
Faceplate adaptor to adapt 1" faceplate to 1-1/8" door preparation.

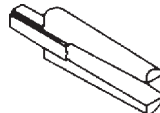

**SC-A700-015**  
AL lever insert before May 2002  
**SC-A700-044** (Special order)  
AL lever insert after May 2002



**SC-A501-311**  
Slide spring for AL Series locks.

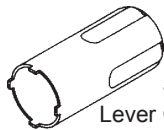

**SC-40-017**  
Lever Castle Nut Wrench

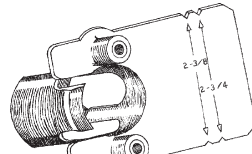

**SC-40-080**  
Thru-bolt Jig

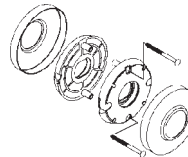

**\$SC-38-075**  
Retrofit Spring Cage Kit  
(Discontinued by Factory)

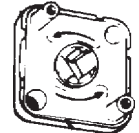

**SC-L283-040**  
L Spring Cage

## SCREW PACKS

Stock No.	Description
<b>SC-B220-050</b>	Adams Rite screw pack for Schlage mortise cylinders.
<b>SC-B610-050</b>	Standard screw pack (2 each) for B660, 661, 663, P&R. 1-3/8" to 2" doors
<b>SC-B610-051</b>	Standard screw pack (2 each) for B660, 661, 663, P&R. Over 2" to 2-1/2" doors
<b>SC-B610-053</b>	Standard screw pack (2 each) for B662P. 1-3/8" to 2" doors
<b>SC-B610-055</b>	Standard screw pack (2 each) for B662P. Over 2" to 2-1/2" doors

## MISCELLANEOUS PARTS (pictured above)

Stock No.	Description
<b>SC-A700-015</b>	AL Series lever insert, 1-3/8" to 1-7/8" doors. (pictured above)
<b>SC-C604-330</b>	D Series lever insert. (pictured above)
<b>SC-B520-322</b>	MD, ME Series. Faceplate for latches. <b>Specify finish: 605 or 626. Discontinued by factory.</b>
<b>\$SC-38-075</b>	Retrofit Spring Cage Kit. Spring cages and roses to convert D-Series lever locks manufactured before 1994. Consist of 1 ea. C303-035, C303-036, C303-438 and 2 ea 04-060. <b>Specify finish: 605, 613, 626.</b> (pictured above) <b>Discontinued by factory. Call for closeout prices.</b>
<b>SC-40-017</b>	AL and D-Series Lever castle nut wrench (metal). (pictured above)
<b>SC-40-080</b>	AL and D-Series lever thru-bolt jig. (pictured above)
<b>SC-L283-040</b>	Spring cage for L Series (1 required per lever). (pictured above)
<b>SC-L283-060</b>	Spindle and spring for L Series for 1-3/8" - 1-7/8" doors (2 required per lock). <b>Not Pictured.</b>

# MISCELLANEOUS PARTS



## Primus Pins and Springs

#1 Finger Pin	<b>Stock No.</b> SP-34-001
#2 Finger Pin	SP-34-002
#3 Finger Pin	SP-34-003
#4 Finger Pin	SP-34-004
#6 Finger Pin	SP-34-006
Finger Pin Spring	SP-C603-951
Everest Check Pin Spring	SP-C603-951
Sidebar Spring	SP-C603-952
Sidebar	SP-C603-950

Top, Master & Bottom pins can be used on Primus & Everest Primus "Controlled Access" and Schlage Standard & Everest Cylinders.

## Regular & Primus Pins and Springs

		<u>*LAB Stock No.</u>
#1 Top Pin	34-101	LB-SC-34-101
#2 Top Pin	34-102	LB-SC-34-102
#3 Top Pin	34-103	LB-SC-34-103
#2 Master Pin	34-202	LB-SC-34-202
#3 Master Pin	34-203	LB-SC-34-203
#4 Master Pin	34-204	LB-SC-34-204
#5 Master Pin	34-205	LB-SC-34-205
#6 Master Pin	34-206	LB-SC-34-206
#7 Master Pin	34-207	LB-SC-34-207
#8 Master Pin	34-208	LB-SC-34-208
#9 Master Pin	34-209	LB-SC-34-209
#0 Bottom Pin	34-300	LB-SC-34-300
#1 Bottom Pin	34-301	LB-SC-34-301
#2 Bottom Pin	34-302	LB-SC-34-302
#3 Bottom Pin	34-303	LB-SC-34-303
#4 Bottom Pin	34-304	LB-SC-34-304
#5 Bottom Pin	34-305	LB-SC-34-305
#6 Bottom Pin	34-306	LB-SC-34-306
#7 Bottom Pin	34-307	LB-SC-34-307
#8 Bottom Pin	34-308	LB-SC-34-308
#9 Bottom Pin	34-309	LB-SC-34-309

\*LAB "Original Pins for Schlage". Sold in plastic Vials.

## F Series Compressible Cylinder

Top T-Pin	<b>Stock No.</b> SC-F506-451
Removable Cap	SC-F506-452
T-Pin Top Spring	SC-F506-453

## Pins and Springs

Pin Tumbler Spring	<b>Stock No.</b> LB-SPR-115L
Cap Retainer Pin Spring	LB-SC-C503-115
SFIC 20S Tumbler Spring	SC-C504-114
Full Size I/C Control Bottom Pin	SC-C603-967
Retainer Cap Pin	LB-SC-C503-116
Retainer Cap	SC-C503-118



**IL-862-00-10 (2CR)**  
Minimum of 10

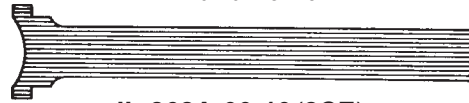

**IL-862A-00-10 (2CE)**  
Minimum of 10



**YA-1145**  
Minimum of 5



**YA-1151**  
.220-24  
Rim Lock Screws



**YA-1151A**  
.220-24  
Rim Lock Screws

**Can't find a part you  
need ?  
Please give us a  
call  
1-800-848-1577**