

SAFE TOOLS

NOSE PULLER FOR SAFE DEPOSIT BOXES

HPC

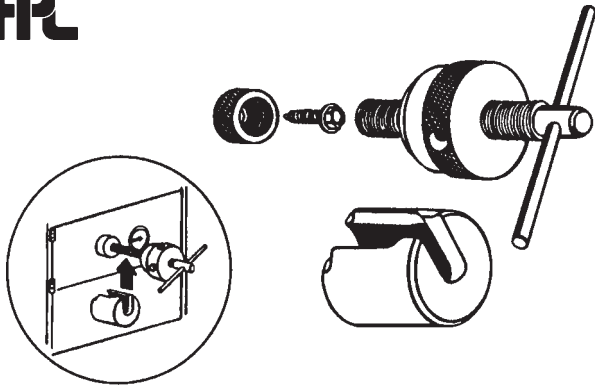

NP-4B

This heavy wrought and bar steel set is expertly machined and finished to effectively pull out a lock core. Simply turn screw into the center of core's keyway to act as an anchor. Then slip the spacer block into place and tighten by turning knurled knob. Continue turning clockwise, slowly and gradually until the entire core is drawn out. Then use the guard key and disengage bolt. If door does not open, then it becomes necessary to use the Door Puller device **DP-7B**. The Nose Puller set is available separately. However, when ordering the **DP-7B** Door Puller set, the Nose Puller set **NP-4B** is included, along with a steel carrying case.

Nose Puller can also be used for removing the plug from a padlock.



Replacement Parts for NP-4B Nose Puller Set

- NP-4B-1** Screw Retainer
- NP-4B-2** Standard Hex Head Sheet Metal Screw, 10 per pack
- NP-4B-3** Threaded Shaft
- NP-4B-4,5** Ball Thrust Bearing and knurled knob
- NP-4B-6** Handle
- NP-4B-7** Spacer Block

DOOR PULLER AND NOSE PULLER FOR SAFE DEPOSIT BOXES

HPC

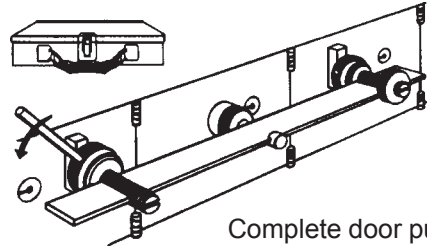

Complete door puller set in position and ready to pull out the safe deposit door.

DP-7B

After the lock core has been pulled and use of the guard key has not opened the door, then it is time to apply the Door Puller set. Place the stepped Spacer Block onto the hook unit. The three different diametered steps make it adaptable to three different sizes of plug bores. Place the correct diameter step into the corresponding bore. Have the hook end set against the inside back wall of the door, Then tighten the knurled nut to hold hook in place. The flat surface on the outside of the hook unit should be in a level position.

The long flat blade is then fitted onto the holding slot, along with the remainder of the Puller unit, as shown above. Position feet of Puller unit onto "Rebates" (partitions between boxes) or away from centers of adjacent doors, so as to minimize the possibility of distortion. The knurled nut is then turned until the door is pulled out.

Replacement Parts for DP-7B Door Puller Set

- DP-7B-1** Hooked Anchoring Post
- DP-7B-2** Knurled Nut only, to fit Anchor post & Leg
- DP-7B-3** 3 Diameter Spacer Block
- DP-7B-4** Flat Blade
- DP-7B-5** Slotted Leg with Foot
- DP-7B-6** Handle
- NP-4B-4,5** Ball Thrust Bearing and Knurled Knob for Thrust Bearing

DOOR PULLER SET DP-7B INCLUDES NOSE PULLER SET NP-4B--ALL WITHIN A CARRYING CASE.

REPLACEMENT PARTS ARE SPECIAL ORDER ONLY.